

## INFORMATION TO BE PROVIDED BY APPLICANTS FOR 2024/2025 FLOODPLAIN ADVICE AND FLOOD INFORMATION



The following information should be provided by the applicant, as applicable. This is a fairly thorough checklist and not all items will be necessary for every application:

---

The **minimum** information to be provided is as follows:

- Name and address of applicant;
  - Permit or reference number (if applicable);
  - Property description; including street address, parish name, CA No, Section No, Lot No, LP or PS details;
  - Purpose of application, *eg* dwelling, subdivision, earthworks;
  - An accurate sketch showing location of proposal on property, *eg* dwelling, earthworks;
  - An accurate locality plan of the property, showing existing property boundaries (and proposed subdivision boundaries if proposed); and
  - A regional locality plan to determine the property's whereabouts within the catchment.
- 

The following additional information **may** be required where applicable:

- Existing and proposed use of the site;
- The number of people expected on site during normal operations;
- An accurate locality plan of the property
  - existing natural surface levels, including levels at the proposed building site and along the access-way to the property boundary;
  - existing and proposed buildings, including floor levels;
  - existing and proposed earthworks, including finished surface levels, embankment alignments and crest levels;
  - existing and proposed fencing;
  - existing and proposed road or access-way alignments and crest levels;
  - existing and proposed drainage systems, including waterways, pipelines, drains, culverts and bridges;
  - other important physical features upstream and downstream of the property that may affect flows, such as levee banks, fences and retaining walls.

INFORMATION TO BE PROVIDED BY APPLICANTS FOR  
2024/2025 FLOODPLAIN ADVICE AND FLOOD INFORMATION



**Regional Locality Plan**

Can be a copy of VicRoads Directory or CFA map.

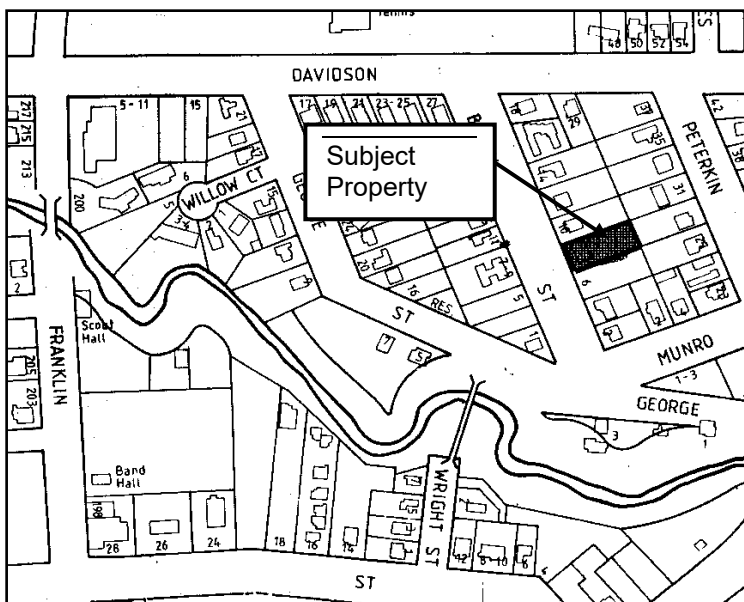

**Locality Plan**

This should show the property boundaries as well as adjacent properties and several identifiable roads.

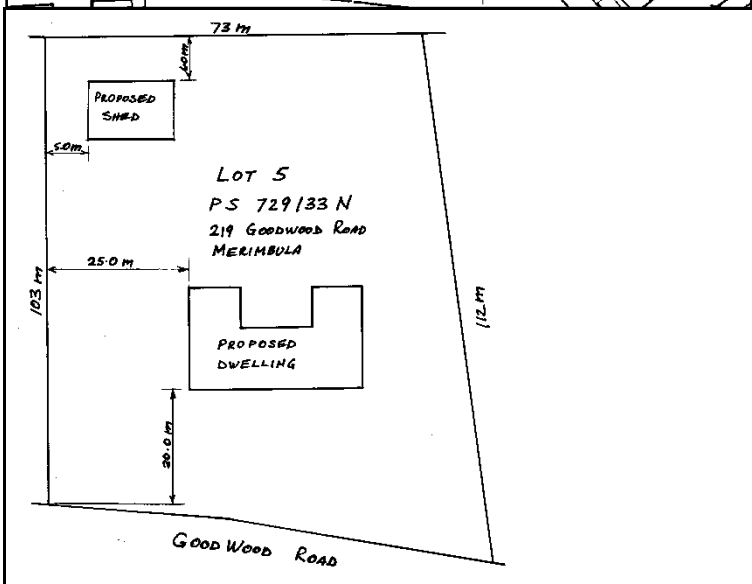

**Sketch of Proposed Works**

This should show a reasonably accurate location of the proposed works within the subject property.

